

ANCHORAGE ANCHORAGE SYSTEMS

ALUMINUM EXTRUSION ANCHORAGE SYSTEM



FOUNDATION

The foundation of an air-supported building is required to overcome the uplift of the building created by the building's internal air pressure.

An aluminum extrusion anchorage system requires a continuous concrete grade beam foundation, which is designed by the Arizon engineering team as part of every project.

Our engineers will design the grade beam footer with respect to the size of the building as well as the snow, wind, and soil conditions at the exact site of the project.

EXTRUSION CHANNEL

The aluminum channel is cast into the grade beam as part of the site work construction phase.

Once in place, the aluminum channel provides an efficient way to securely lock the fabric membrane into place prior to inflating the air-supported building during installation.

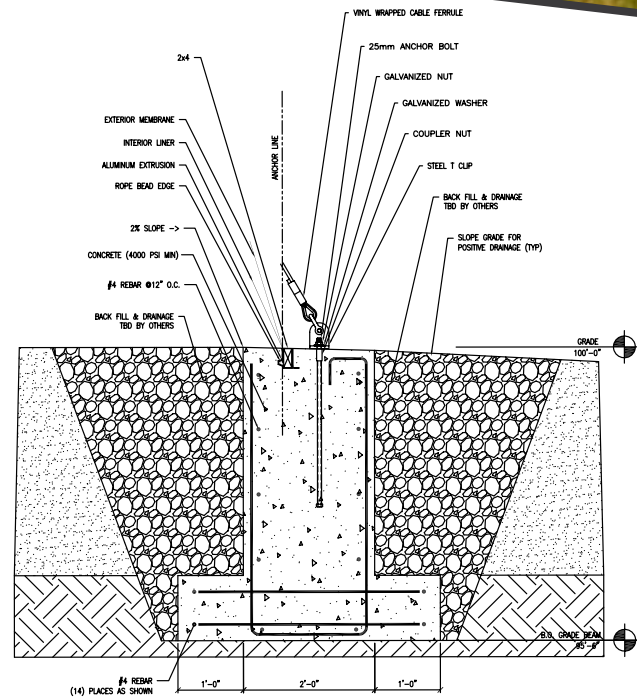

ARIZON
BUILDING SYSTEMS

(800) 325-1303
11880 Dorsett Road,
St. Louis, MO 63043
ArizonBuildingSystems.com